

Dishwash Detergent for Softened Water

Product Usage Guide

Professional

BB075-10



Automatic Dishwashing Machines

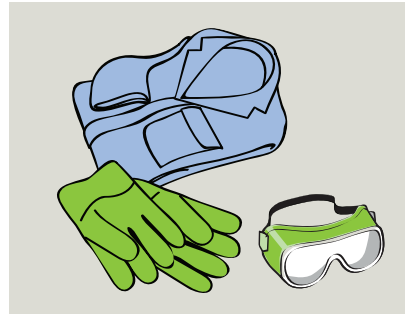

1 Use appropriate PPE as indicated in COSHH/REACH data.

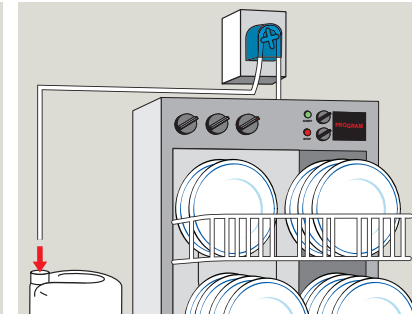

2 Connect product to electronic dosing system following manufacturers instructions.

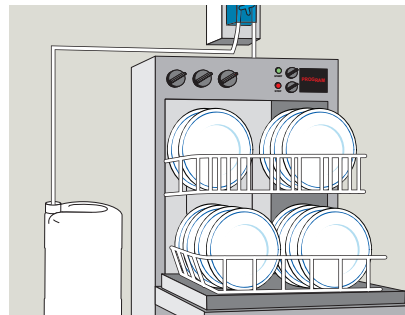

3 Product should be diluted at the rate of 1-3ml of detergent per litre of water.

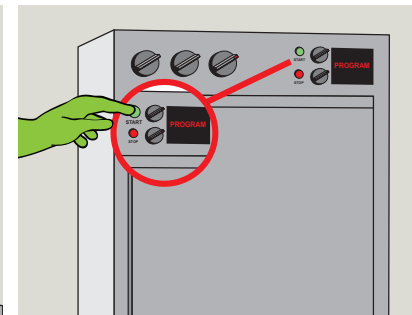

4 Select program and press start.

Health & Safety

Please refer to relevant COSHH Safety Data Sheet



Scan for further product details



Not to be used for manual dishwashing.