

# Contract Lemon All-purpose Cleaner



When dosing concentrate chemicals always use the recommended PPE, and always read the labels to check best practice for handling both the undiluted & ready to use solutions.

## Product Usage Guide

contract



### BA813-5



| Recommended Dosage          |                                  |
|-----------------------------|----------------------------------|
| General Cleaning            | 1:50<br>1 part to 50 parts water |
| Heavy Impacted Oil & Grease | 1:10<br>1 part to 10 parts water |
| All Stone Floors            | 1:20<br>1 part to 20 parts water |

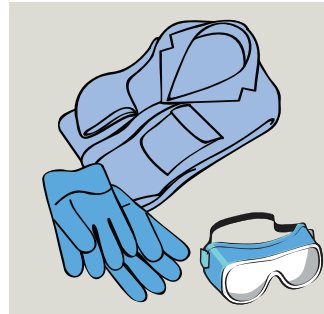

**1** Use appropriate PPE as indicated in the Safety Data Sheet.



**2** Place Safety Signs.



**3** Dilute at recommended dosage.

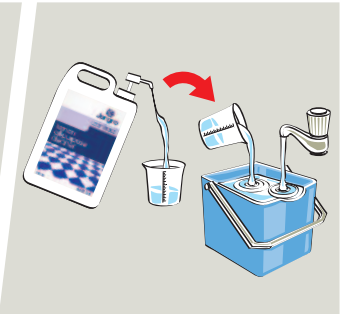

**4** Wipe with cloth or mop.



**5** Once surface is dry remove Safety Signs.

### Health & Safety

Please refer to relevant COSHH Safety Data Sheet



Scan for further product details